

Metric Steel Gears

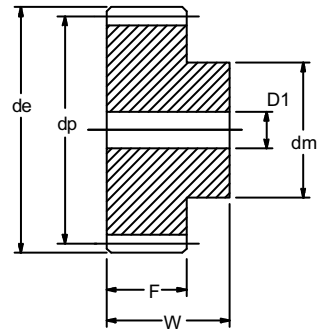

Type B

(Above Bold Horizontal Line)

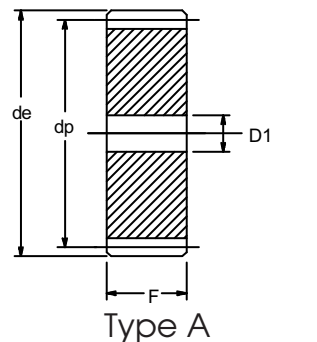

Type A

(Below Bold Horizontal Line)

Full Width "W"

Module 1	= 25 mm
Module 1.5	= 30 mm
Module 2	= 35 mm
Module 2.5	= 45 mm
Module 3	= 50 mm
Module 4	= 60 mm
Module 5	= 75 mm
Module 6	= 75 mm
Module 8	= 95 mm

Tooth Face Width "F"

Module 1	= 15 mm
Module 1.5	= 17 mm
Module 2	= 20 mm
Module 2.5	= 25 mm
Module 3	= 30 mm
Module 4	= 40 mm
Module 5	= 50 mm
Module 6	= 50 mm
Module 8	= 64 mm

Circular Pitch

Module 1	= 3.142 mm
Module 1.5	= 4.712 mm
Module 2	= 6.283 mm
Module 2.5	= 7.854 mm
Module 3	= 9.425 mm
Module 4	= 12.566 mm
Module 5	= 15.708 mm
Module 6	= 18.850 mm
Module 8	= 25.13

Material: AISI C1040

20° pressure angle

D1 = ±1 mm

Teeth Z	Module 1						Module 1.5						Module 2					
	de	dp	dm	D1 ±1	kg		de	dp	dm	D1 ±1	kg		de	dp	dm	D1 ±1	kg	
12	14	12	9	6	0.012		21.0	18.0	14	8	0.030		28	24	18	10	0.68	
13	15	13	10	6	0.013		22.5	19.5	14-15	8	0.038		30	26	19-20	10	0.084	
14	16	14	10-11	6	0.015		24.0	21.0	17-18	8	0.046		32	28	20-22	10	0.100	
15	17	15	12	6	0.016		25.5	22.5	18	8	0.057		34	30	22-24	10	0.118	
16	18	16	13	6	0.017		27.0	24.0	20	8	0.060		36	32	24-25	10	0.134	
17	19	17	14	6-8	0.022		28.5	25.5	20	8	0.068		38	34	25	10-12	0.160	
18	20	18	15	8	0.024		30.0	27.0	20	8-10	0.073		40	36	25	10-12	0.166	
19	21	19	15	8	0.026		31.5	28.5	20	8-10	0.082		42	38	25	10-12	0.180	
20	22	20	16	8	0.027		33.0	30.0	25	8-10	0.097		44	40	30	10-12	0.195	
21	23	21	16	8	0.036		34.5	31.5	25	10	0.110		46	42	30	12-14	0.218	
22	24	22	16-18	8	0.038		36.0	33.0	25	10	0.118		48	44	30	12-14	0.238	
23	25	23	18	8	0.042		37.5	34.5	25	10	0.126		50	46	30	12-14	0.255	
24	26	24	20	8-10	0.044		39.0	36.0	25	10-12	0.135		52	48	35	12-14	0.272	
25	27	25	20	8-10	0.045		40.5	37.5	25	10-12	0.142		54	50	35	12-14	0.285	
26	28	26	20	8-10			42.0	39.0	30	12			56	52	40	12-14		
27	29	27	20	8-10			43.5	40.5	30	12			58	54	40	12-14		
28	30	28	20	8-10	0.054		45.0	42.0	30	12	0.178		60	56	40	12-14	0.406	
29	31	29	20	8-10			46.5	43.5	30	12			62	58	40	14		
30	32	30	20	8-10	0.059		48.0	45.0	30	12	0.195		64	60	40	14	0.448	
31	33	31	25	8-10			49.5	46.5	35	12			66	62	45	14		
32	34	32	25	10			51.0	48.0	35	12			68	64	45	14		
33	35	33	25	10			52.5	49.5	35	12			70	66	45	14		
34	36	34	25	10			54.0	51.0	35	12			72	68	45	14		
35	37	35	25	10			55.5	52.5	35	12			74	70	45	14		
36	38	36	25	10	0.094		57.0	54.0	35	12	0.315		76	72	45	14	0.670	
37	39	37	25	10			58.5	55.5	40	12-14			78	74	50	14-16		
38	40	38	25	10	0.098		60.0	57.0	40	12-14	0.348		80	76	50	14-16	0.710	
39	41	39	25	10			61.5	58.5	40	12-14			82	78	50	14-16		
40	42	40	25	10	0.108		63.0	60.0	40	12-14	0.355		84	80	50	14-16	0.760	
41	43	41	30	10			64.5	61.5	40-50	12-15			86	82	55-60	16		
42	44	42	30	10			66.0	63.0	50	12-15			88	84	55-60	16		
43	45	43	30	10			67.5	64.5	50	12-15			90	86	55-60	16		
44	46	44	30	10			69.0	66.0	50	12-15			92	88	60	16		
45	47	45	30	10	0.145		70.5	67.5	50	12-15	0.445		94	90	60	16	1.072	
46	48	46	30	10			72.0	69.0	50	14-15			96	92	60	16		
47	49	47	30	10			73.5	70.5	50	14-15			98	94	60-70	16		
48	50	48	30	10	0.160		75.0	72.0	50	14-15	0.525		100	96	70	16	1.181	
49	51	49	30	10			76.5	73.5	50	14-15			102	98	70	16		
50	52	50	30	12	0.185		78.0	75.0	50	14-15	0.560		104	100	70	16	1.351	
51	53	51	40	12			79.5	76.5	60	14-15			106	102	70	16-20		
52	54	52	40	12	0.190		81.0	78.0	60	14-15	0.590		108	104	70	16-20	1.433	
53	55	53	40	12			82.5	79.5	60	14-15			110	106	70	16-20		
54	56	54	40	12			84.0	81.0	60	14-15			112	108	70	16-20		
55	57	55	40	12			85.5	82.5	60	14-15			114	110	70	16-20		
56	58	56	40	12	0.210		87.0	84.0	60	15-16	0.660		116	112	70	16-20	1.606	
57	59	57	40	12			88.5	85.5	60	15-16			118	114	70	16-20		
58	60	58	40	12			90.0	87.0	60	15-16			120	116	70	16-20		
59	61	59	40	12			91.5	88.5	60	15-16			122	118	70	16-20		
60	62	60	40	12	0.260		93.0	90.0	60	15-16	0.815		124	120	70	16-20	1.910	
61	63	61	50	12			94.5	91.5	70	16-20			126	122	80	16-20		
62	64	62	50	12			96.0	93.0	70	16-20			128	124	80	16-20		
63	65	63	50	12			97.5	94.5	70	16-20			130	126	80	16-20		
64	66	64	50	12			99.0	96.0	70	16-20			132	128	80	16-20		
65	67	65	50	12			100.5	97.5	70	16-20			134	130	80	16-20		
66	68	66	50	12			102.0	99.0	70	16-20			136	132	80	16-20		
67	69	67	50	12			103.5	100.5	70	16-20			138	134	80	16-20		
68	70	68	50	12			105.0	102.0	70	16-20			140	136	80	16-20		
69	71	69	50	12			106.5	103.5	70	16-20			142	138	80	16-20		
70	72	70	50	12			108.0	105.0	70	16-20			144	140	80	16-20		
72	74	72	12				111.0	108.0	16-20				148	144	16-20			
75	77	75	12				115.5	112.5	16-20				154	150	20			
76	78	76	12	0.274			117.0	114.0	16-20	0.895			156	152	20	2.240		
80	82	80	12	0.298			123.0	120.0	16-20	1.031			164	160	20	2.474		
85	87	85	12				130.5	127.5	16-20				174	170	20			
90	92	90	12				138.0	135.0	16-20				184	180	20			
95	97	95	12	0.430			145.5	142.5	16-20	1.450			194	190	20	3.520		
100	102	100	12				153.0	150.0	16-20				204	200	20			
110	112	110	12				168.0	165.0	16-20				224	220	20			
114	116	114	12				174.0	171.0	16-20				232	228	20			
120	122	120	12	0.675			183.0	180.0	16-20	2.336			244	240	20	5.587		
127	129	127	12				193.5	190.5	16-20				258	254	20			

Minimum Plain Bore Gears to DIN 782 Grade 8-9



American Metric® Corporation

GROUP: 025

1-025-060224

Metric Steel Gears

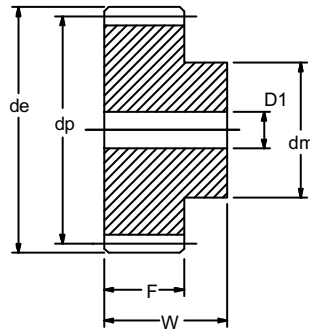

Type B

(Above Bold Horizontal Line)

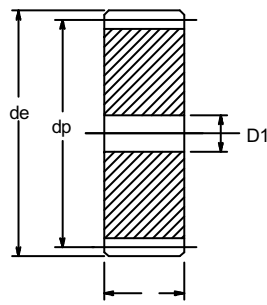

Type A

(Below Bold Horizontal Line)

Full Width "W"

Module 1	= 25 mm
Module 1.5	= 30 mm
Module 2	= 35 mm
Module 2.5	= 45 mm
Module 3	= 50 mm
Module 4	= 60 mm
Module 5	= 75 mm
Module 6	= 75 mm
Module 8	= 95 mm

Tooth Face Width "F"

Module 1	= 15 mm
Module 1.5	= 17 mm
Module 2	= 20 mm
Module 2.5	= 25 mm
Module 3	= 30 mm
Module 4	= 40 mm
Module 5	= 50 mm
Module 6	= 50 mm
Module 8	= 64 mm

Circular Pitch

Module 1	= 3.142 mm
Module 1.5	= 4.712 mm
Module 2	= 6.283 mm
Module 2.5	= 7.854 mm
Module 3	= 9.425 mm
Module 4	= 12.566 mm
Module 5	= 15.708 mm
Module 6	= 18.850 mm
Module 8	= 25.13

Material: AISI C1040

20° pressure angle

D1 = ±1 mm

Teeth Z	Module 2.5					Module 3					Module 4				
	de	dp	dm	D1 ±1 kg		de	dp	dm	D1 ±1 kg		de	dp	dm	D1 ±1 kg	
12	35.0	30.0	22	10	0.130	42	36	25-27	12	0.217	56	48	35	14-15	0.500
13	37.5	32.5	25	10	0.155	45	39	25-30	12	0.270	60	52	40	14-15	0.605
14	40.0	35.0	28	10	0.190	48	42	25-33	12	0.325	64	56	45	14-15	0.735
15	42.5	37.5	30	10	0.200	51	45	35	12-15	0.375	68	60	45	14-15	0.796
16	45.0	40.0	32	12	0.225	54	48	38	14-15	0.388	72	64	50	15-16	0.992
17	47.5	42.5	35	12	0.280	57	51	42	14-15	0.480	76	68	50	16-20	1.083
18	50.0	45.0	35	12	0.286	60	54	45	14-15	0.500	80	72	50	16-20	1.150
19	52.5	47.5	35	12	0.305	63	57	45	14-15	0.550	84	76	60	16-20	1.263
20	55.0	50.0	40	12-14	0.340	66	60	45	14-15	0.600	88	80	60	16-20	1.383
21	57.5	52.5	40	14	0.432	69	63	45	15-16	0.720	92	84	70	16-20	1.632
22	60.0	55.0	45	14	0.467	72	66	50	15-16	0.775	96	88	70	16-20	1.770
23	62.5	57.5	45	14	0.490	75	69	50	15-16	0.845	100	92	75	20	1.909
24	65.0	60.0	45	14	0.515	78	72	50	16	0.860	104	96	75	20	2.060
25	67.5	62.5	50	14	0.550	81	75	60	16	0.955	108	100	75	20	2.220
26	70.0	65.0	50	14-16		84	78	60	16		112	104	75	20	
27	72.5	67.5	50	14-16		87	81	60	16		116	108	75	20	
28	75.0	70.0	50	14-16	0.735	90	84	60	16	1.344	120	112	75	20	3.000
29	77.5	72.5	50	14-16		93	87	60	16		124	116	75	20	
30	80.0	75.0	55	14-16	0.860	96	90	60	16	1.450	128	120	75	20	3.290
31	82.5	77.5	55	16		99	93	60-70	16-20		132	124	80	20	
32	85.0	80.0	55	16		102	96	70	16-20		136	128	80	20	
33	87.5	82.5	55	16		105	99	70	16-20		140	132	80	20	
34	90.0	85.0	55	16		108	102	70	16-20		144	136	80	20	
35	92.5	87.5	60	16		111	105	70	16-20		148	140	80	20	
36	95.0	90.0	60	16	1.230	114	108	70	20	2.150	152	144	80	25	3.910
37	97.5	92.5	60	16		117	111	70-80	20						
38	100.0	95.0	60	16		120	114	80	20	2.329	160	152		25	4.400
39	102.5	97.5	60	16		123	117	80	20						
40	105.0	100.0	70	16-20	1.378	126	120	80	20	2.680	168	160		25	4.920
41	107.5	102.5	70	16-20		129	123	80-90	20						
42	110.0	105.0	70	16-20		132	126	80-90	20						
43	112.5	107.5	70	16-20		135	129	80-90	20						
44	115.0	110.0	70	16-20		138	132	90	20						
45	117.5	112.5	70	16-20	1.950	141	135	90	20	2.700	188	180		25	6.230
46	120.0	115.0	70	20		144	138	90	20						
47	122.5	117.5	80	20		147	141	90-100	20						
48	125.0	120.0	80	20	2.160	150	144	100	20	3.100	200	192		25	7.050
49	127.5	122.5	80	20											
50	130.0	125.0	80	20	2.400	156	150		20-25	3.364	208	200		25	7.700
51	132.5	127.5	80	20											
52	135.0	130.0	90	20	2.560	162	156		20-25	3.510	216	208		25	8.270
53	137.5	132.5	90	20											
54	140.0	135.0	90	20											
55	142.5	137.5	90	20		171	165		20-25		228	220		25	
56	145.0	140.0	100	20											
57	147.5	142.5	100	20		177	171		20-25		236	228		25	
58	150.0	145.0	100	20											
59	152.5	147.5	100	20											
60	155.0	150.0	100	20	2.900	186	180		20-25	4.840	248	240		25	11.060
61															
62															
63															
64															
65	167.5	162.5		20		201	195		20-25		268	260		25	
66															
67															
68															
69															
70	180.0	175.0		20		216	210		25		288	280		25	
72	185.0	180.0		20		222	216		25						
75	192.5	187.5		20		231	225		25		308	300		25	
76	195.0	190.0		20	4.363	234	228		25	7.813	312	304		25-30	17.800
80	205.0	200.0		25	4.839	246	240		25	8.600	328	320		25-30	19.800
85	217.5	212.5		25		261	255		25		348	340		25-30	
90	230.0	225.0		25		276	270		25		368	360		25-30	
95	242.5	237.5		25	6.852	291	285		25	12.290	388	380		25-30	28.100
100	255.0	250.0		25		306	300		25		408	400		25-30	
110	280.0	275.0		25		336	330		25		448	440		25-30	
114	290.0	285.0		25		348	342		25-30		464	456		25-30	
120	305.0	300.0		25		366	360		25-30						
127	322.5	317.5		25		387	381		25-30						

Metric Steel Gears

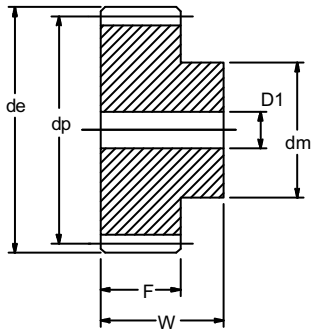

Type B

(Above Bold Horizontal Line)

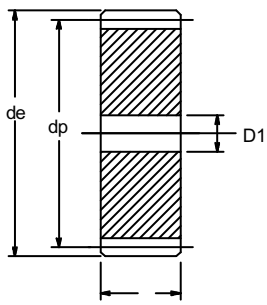

Type A

(Below Bold Horizontal Line)

Full Width "W"

Module 1	= 25 mm
Module 1.5	= 30 mm
Module 2	= 35 mm
Module 2.5	= 45 mm
Module 3	= 50 mm
Module 4	= 60 mm
Module 5	= 75 mm
Module 6	= 75 mm
Module 8	= 95 mm

Tooth Face Width "F"

Module 1	= 15 mm
Module 1.5	= 17 mm
Module 2	= 20 mm
Module 2.5	= 25 mm
Module 3	= 30 mm
Module 4	= 40 mm
Module 5	= 50 mm
Module 6	= 50 mm
Module 8	= 64 mm

Circular Pitch

Module 1	= 3.142 mm
Module 1.5	= 4.712 mm
Module 2	= 6.283 mm
Module 2.5	= 7.854 mm
Module 3	= 9.425 mm
Module 4	= 12.566 mm
Module 5	= 15.708 mm
Module 6	= 18.850 mm
Module 8	= 25.13 mm

Material: AISI C1040
20° pressure angle
D1 = ±1 mm

Teeth Z	Module 5					Module 6					Module 8				
	de	dp	dm	D1	kg	de	dp	dm	D1	kg	de	dp	dm	D1	kg
12	70	60	45	16-20	0.99	84	72	54	20	1.70					
13	75	65	50	16-20	1.22	90	78	60	20	2.03					
14	80	70	55	20	1.45										
15	85	75	60	20	1.50	102	90	70	20	2.56	136.0	120.0	80	25	7.24
16	90	80	65	20	1.69	108	96	75	20	3.16					
17	95	85	70	20	2.08										
18	100	90	70	20	2.15	120	108	80	20	3.79					
19	105	95	70	20	2.50										
20	110	100	80	20	2.61	132	120	90	20	4.60	176.0	160.0	100	30	12.80
21	115	105	80	20	3.11										
22	120	110	80	20-25	3.40										
23	125	115	90	20-25	3.74										
24	130	120	90	20-25	3.85	156	144	110	25	6.53					
25	135	125	90	20-25	4.30	162	150	110	25	7.02	216.0	200.0	125	30	21.50
26	140	130	100	20-25	4.40										
27	145	135	100	20-25	4.50										
28	150	140	100	25	4.60										
29	155	145	100-110	25	4.90										
30	160	150	100-110	25	5.25										
31															
32	170	160		25		180	180		25	9.23	256.0	240		30	39.00
33															
34															
35	185	175		25		204	192		25	12.23					
36															
37															
38	200	190		25-30	8.50	222	210		25	16.61					
39															
40	210	200		25-30	9.58	240	228		25	14.80					
41															
42															
43															
44															
45	235	225		25-30	12.10	240	240		25	16.61	336	320		40	52.50
46															
47															
48	250	240		25-30	13.60										
49															
50	260	250		30	15.00										
51															
52	270	260		30	16.40										
53															
54															
55	285	275		30											
56															
57	295	285		30											
58															
59															
60	310	300		30	21.60						496	480		50	72.50
61															
62															
63															
64															
65	335	325		30											
66															
67															
68															
69															
70	360	350		30											
71															
72															
75	385	375		30											
76	390	380		30											
80	410	400		30	39.00										
85	435	425		30											
90	460	450		30											
95	485	475		30	55.00										
100	510	500		30											
110	560	550		30											
114	580	570		30											
120															
127															

Part Number Examples:

M3B21

M3 = 3 module

B = with hub

21 = number of teeth

SSM2.5A80

SS = Stainless Steel

M2.5 = 2.5 module

A = without hub

80 = number of teeth